

LED LINEAR LIGHT, SELECTABLE 5CCTI
TEM:4101-42L-MB-LED
4101-54L-MB-LED

Z-Lite
Est. 1987

FOR YOUR SAFETY WARNING



Risk of Fire, Consult a qualified electrician to ensure correct branch circuit conductor. Turn off the main power at the circuit breaker before installing the fixture in order to prevent possible shock.

General

All electrical connections must be in accordance with local and National Electrical Code (N.E.C.) standards. If you are unfamiliar with proper electrical wiring connections, obtain the services of a qualified electrician. Remove the fixture and the mounting package from the box and make sure that no parts are missing by referencing the illustration.

Please consult a qualified electrician for hanging fixture and w

CAUTION: Before starting the installation, disconnect removing the fuse at the fuse box.

Carefully unpack and identify all parts before assembly.

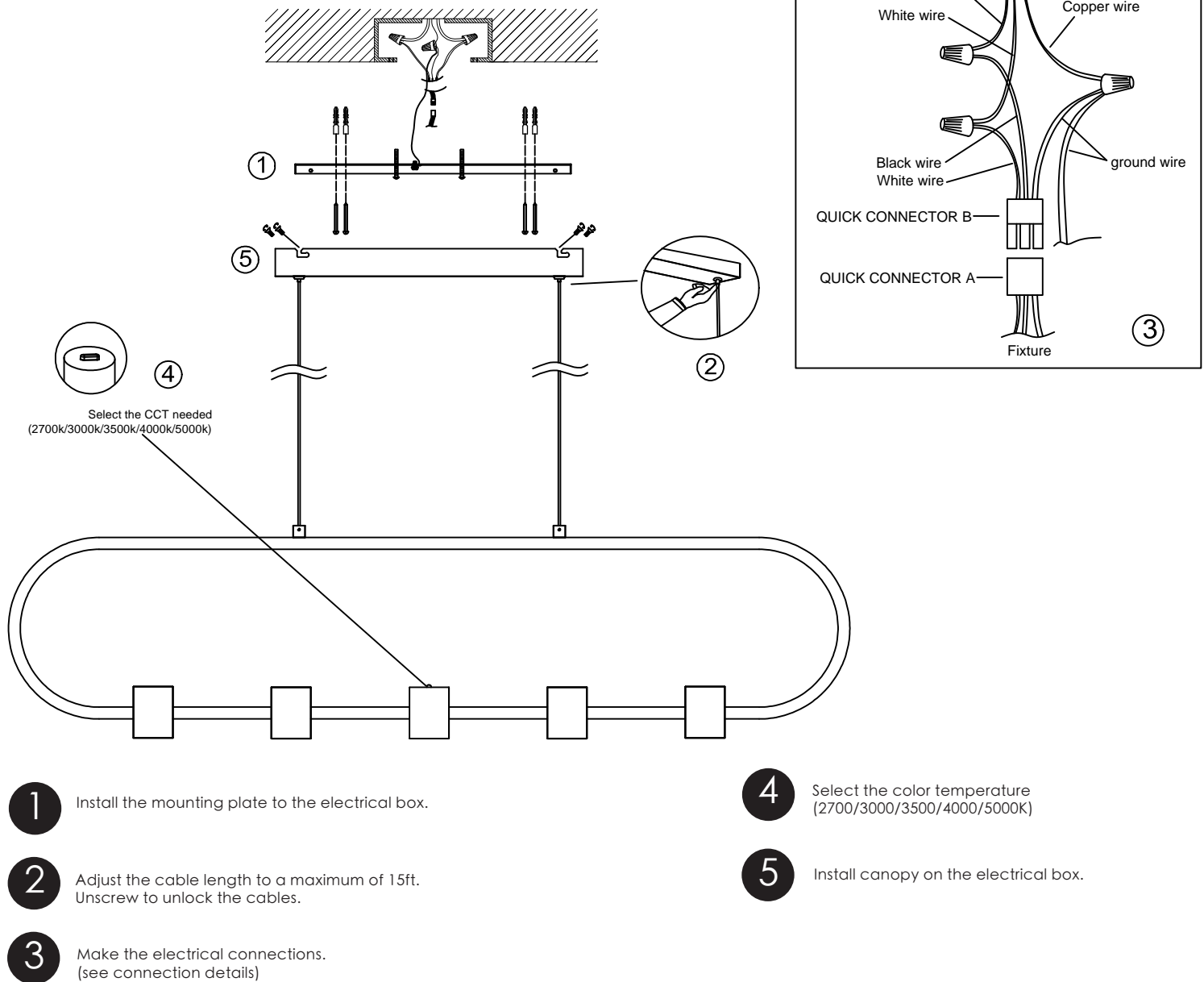

"To clean, wipe fixture with a damp soft cloth. Then dry immediately with a dry soft cloth. Clean glass with a mild soap. DO NOT use chemical cleaners or abrasive materials such as scouring pads or powders, steel wool or abrasive paper."

Note: The quick connectors have been included on the fixture to allow for ease of installation when replacing your fixture in future. Simply disconnect your fixture by separating A+B and replace with new fixture connecting A+B.